

PowerConnect

Overview of supported moment connection types

MOMENT CONNECTIONS	SHEAR CONNECTIONS	HOLLOW STRUCTURAL SECTION CONNECTIONS
--------------------	-------------------	---------------------------------------

SINGLE-SIDED BEAM TO COLUMN FLANGE

Welded

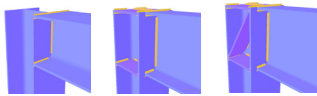

Bolted moment end plate

flush end plate

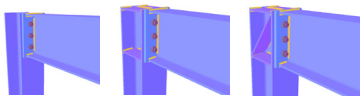

extended end plate on 1 side

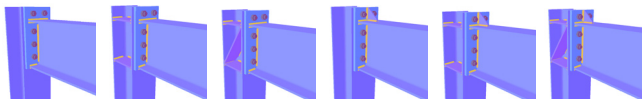

extended end plate on 2 sides

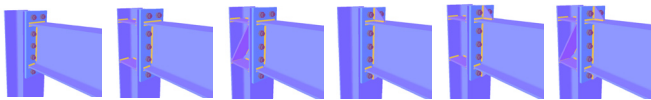

Haunched beam welded

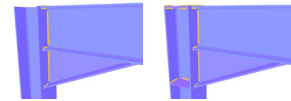

Haunched beam end plate

flush end plate

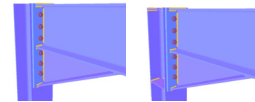

extended end plate

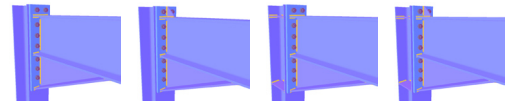

bolted angle cleats

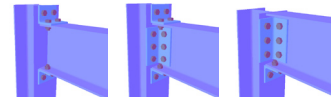

SINGLE-SIDED BEAM-TO-COLUMN WEB

Welded

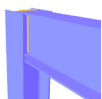

Bolted moment end plate

flush end plate

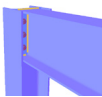

extended end plate on 1 side

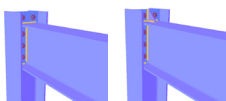

extended end plate on 2 sides

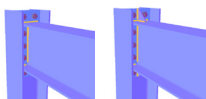

Haunched beam welded

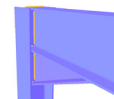

Haunched beam end plate

flush end plate

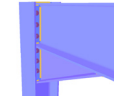

extended end plate

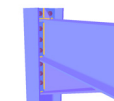

bolted angle cleats (on beam flanges and/or beam web)

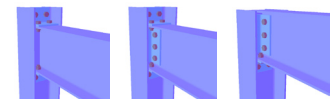

DOUBLE-SIDED BEAM TO COLUMN FLANGE

Welded

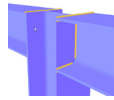

Bolted moment end plate

flush end plate

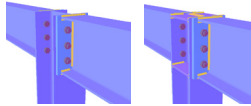

extended end plate on 1 side

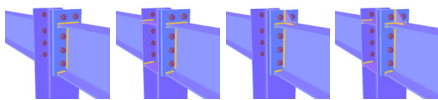

extended end plate on 2 sides

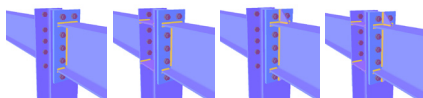

Haunched beam welded

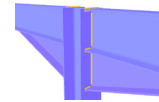

Haunched beam end plate

flush end plate

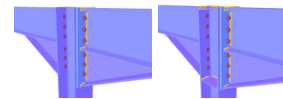

extended end plate



bolted angle cleats (on beam flanges and/or beam web)

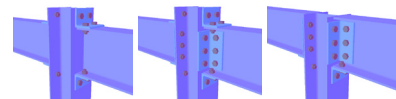

BEAM TO BEAM

Welded



Bolted moment end plate

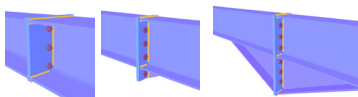

Bolted angle cleats

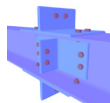

Bolted splice

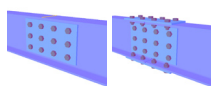

COLUMN BASE PLATE

Flush base plate

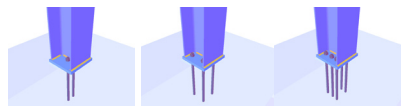

Extended base plate (1-sided)



Extended base plate (2-sided - 2 anchor bolts)

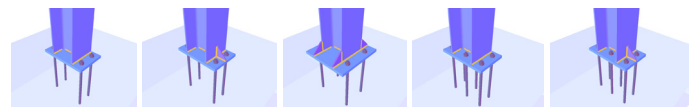

Extended base plate (2-sided - 3 anchor bolts)

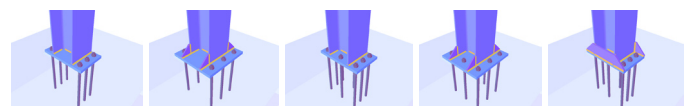

For more information on PowerConnect, please contact:

PowerConnect is a product of BuildSoft NV

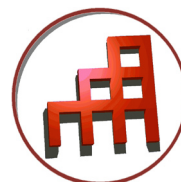

Hundelgemsesteenweg 244/1
 B-9820 Merelbeke, België
 ☎ +32 (0)9 252 66 28
 📠 +32 (0)9 252 66 29
 ✉ info@buildsoft.eu
 🌐 www.buildsoft.eu